

Monday, January 13, 2020 4:44:17 PM E:\2019\19029.00\Food Lion Store 2250 Morganton NC\Working\A1.03B.dwg

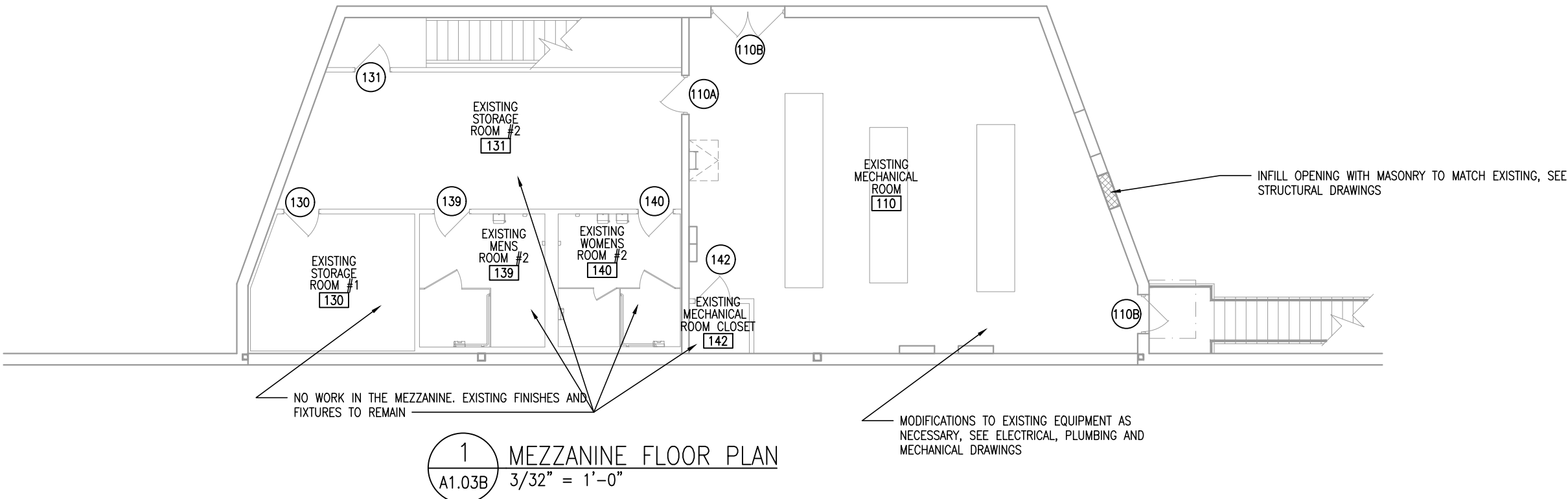

GENERAL NOTES:

1. FOOD LION WILL BE SUPPLYING THE NECESSARY AUTOMATIC DOORS, CONTROL PANELS, INTERIOR LIGHTING, IMPACT DOORS, SINKS, WATER FOUNTAINS, WATER HEATERS, AQUARIAT & STANDS, HAND DRYERS AND HVAC EQUIPMENT FOR THIS PROJECT. INSTALLATION AND WARRANTIES OF THIS EQUIPMENT IS TO BE SUPPLIED BY THE GENERAL CONTRACTOR. THE GENERAL CONTRACTOR IS RESPONSIBLE FOR ORDERING THESE ITEMS DIRECTLY FROM THE SUPPLIER AS SOON AS THE CONTRACT IS AWARDED. THE ITEMS MUST BE STORED ON SITE IN STORAGE TRAILERS. A COMPLETE PACKAGE WITH THE INFORMATION WILL BE SENT TO THE AWARDING GENERAL CONTRACTOR. THESE ITEMS, WITH THE EXCEPTION OF INSTALLATION AND WARRANTY, MUST BE EXCLUDED FROM THE BID. SEE SHEET A1.01

2. METAL FLASHING BETWEEN ALL WALK-IN COOLERS, FREEZERS AND ADJACENT WALLS TO BE FURNISHED AND INSTALLED BY COOLER MANUFACTURER. ADDITIONALLY, A #16 MESH SCREEN CLOSURE FOR THE SAME SPACE ON TOP OF EACH COOLER & FREEZER TO ALSO BE PROVIDED AND INSTALLED BY THE MANUFACTURER. (1/4" HARDWARE CLOTH).

3. ALL CONTRACTORS SHALL HAVE A STORAGE TRAILER FOR STORAGE OF MATERIALS AND EQUIPMENT WHEN NOT IN USE. ANY MATERIALS LEFT IN AN AREA THAT HINDERS STORE OPERATIONS WILL BE DISCARDED. COORDINATE WITH FOOD LION CONSTRUCTION MANAGER.

4. GENERAL CONTRACTORS SHALL GROUT THE GAP BETWEEN WALK-IN FREEZERS AND EDGE OF DEPRESSED SLAB IF APPLICABLE.

5. GENERAL CONTRACTOR SHALL BE RESPONSIBLE FOR FINAL CLEANING AND SANITIZING ALL PREPS, RESTROOMS AND DELI/BAKERY. THE WORK MUST BE APPROVED BY FOOD LION CONSTRUCTION MANAGER.

6. GENERAL CONTRACTOR TO VERIFY ALL EXISTING DIMENSIONS.

7. GENERAL CONTRACTOR IS TO ENCLOSE THE AREAS ABOVE ALL ROOMS AND EXPOSED WALK-IN COOLERS/ FREEZERS IN GROCERY STAGING/ RECEIVING AREAS (IF NOT EXISTING OR REPAIR IF DAMAGED) WITH 2x4 WELDED WIRE ON 3 5/8" METAL STUDS @ 24" O.C. RUN STUDS TO THE ROOF DECKING. GENERAL CONTRACTOR TO PROVIDE 30"x48" ACCESS DOORS IN WIRE ABOVE AS REQUIRED FOR MAINTENANCE ACCESS.

8. CONTRACTOR SHALL VERIFY LOCATION OF ALL UTILITIES. ALL RELOCATION OF UTILITIES SHALL BE COORDINATED WITH THE FOOD LION CONSTRUCTION MANAGER AND/OR LOCAL UTILITIES.

9. GENERAL CONTRACTOR IS RESPONSIBLE FOR SEALING ALL OPENINGS/PENETRATIONS IN THE MECHANICAL ROOM AIR-TIGHT.

10. GENERAL CONTRACTOR SHALL BE RESPONSIBLE FOR SUPPLYING AND INSTALLING THE MINIMUM AMOUNT OF FIRE EXTINGUISHERS AS FOLLOWS:
8 - 5 LBS. ABC
1 - 10 LBS. ABC (BALER)
1 - 6 Liter Class K (DELI/BAKERY)

(PROVIDE ADDITIONAL EXTINGUISHERS IF INDICATED ON PLAN)

THE ACCEPTABLE MANUFACTURERS OF THESE FIRE EXTINGUISHERS ARE SENTRY, ANSUL, AND BAKER. THE GENERAL CONTRACTOR SHALL COORDINATE LOCATIONS OF FIRE EXTINGUISHERS WITH THE FOOD LION CONSTRUCTION MANAGER. FIVE-POUND ABC RATED PORTABLE FIRE EXTINGUISHERS WILL BE REQUIRED SO THAT THERE IS NO MORE THAN 50 FEET OF TRAVEL TO AN EXTINGUISHER. THE GENERAL CONTRACTOR SHALL ALSO BE RESPONSIBLE FOR SUPPLYING AND INSTALLING ANY ADDITIONAL FIRE EXTINGUISHERS THAT MAY BE REQUIRED BY LOCAL FIRE CODES. THE GENERAL CONTRACTOR SHALL BE RESPONSIBLE FOR RECHARGING AND UPDATING OF EXISTING EXTINGUISHERS.

11. THE GENERAL CONTRACTOR SHALL INSTALL EXTERIOR MOUNTED GUARD POSTS AS INDICATED ON SITE-SPECIFIC A1.01 AND THE FOOD LION CONSTRUCTION MANAGER.

12. GENERAL CONTRACTOR SHALL SUPPLY AND INSTALL TOILET PARTITIONS AS DESCRIBED ON SHEET A4.03 AND IN THE SPECIFICATIONS.

13. THE GENERAL CONTRACTOR SHALL PRESSURE WASH JANITOR'S ROOM/PREP CLOSET FLOORS, WALLS AND CAN WASH.

14. THE GENERAL CONTRACTOR SHALL CAULK AT TOP AND BOTTOM OF WOOD BASEBOARD AT WALK-IN COOLERS AND FREEZERS AFTER REPAINTING; REMOVE WOOD BASEBOARDS AT ALL CMU WALLS.

15. GENERAL CONTRACTOR SHALL CAULK AROUND ALL FIXTURES/WALL FASTENED ACCESSORIES IN RESTROOMS/ALL CORRIDORS/PREP ROOMS AND OFFICES THROUGHOUT THE ENTIRE STORE (WATER FOUNTAINS, SINKS, PAPER TOWEL HOLDERS, ELECTRICAL PLATE COVERS, PLUMBING FIXTURES, PLUMBING ESCUTCHEONS, ELECTRICAL OUTLETS, SPRINKLER ESCUTCHEONS AND WALL MOUNTED FIXTURES, ETC.) CAULK COLOR TO MATCH FIXTURES.

16. GENERAL CONTRACTOR SHALL INSTALL CONTROL JOINTS IN NEW GYPSUM BOARD WALL FINISH IN SALES AREA AS REQUIRED BY MANUFACTURER - SEE DETAIL 12/A5.01 - AT A MINIMUM, SPACING SHALL BE 30'-0" O.C.

17. ALL NEW PLYWOOD WORK IS TO BE FIRE RETARDANT TREATED PLYWOOD.

18. THE REFRIGERATION CONTRACTOR SHALL BE RESPONSIBLE FOR INSTALLATION OF ALL NEW RETROFIT DOORS.

19. THE INTENTION OF FOOD LION IS TO COMPLY WITH ALL REQUIREMENTS SET FORTH IN THE AMERICANS WITH DISABILITY ACT.

20. ALL CONTRACTORS AND SUBCONTRACTORS SHALL COMPLY WITH ALL FEDERAL, STATE AND LOCAL CODES

21. IF NEW SIGNAGE IS REQUIRED, THE GENERAL CONTRACTOR SHALL VERIFY WITH LOCAL SIGN ORDINANCE THAT THE "FOOD LION" SIGN MEETS ALL REQUIREMENTS OF THE ORDINANCE.

22. THE GENERAL CONTRACTOR SHALL SUPPLY ALL SIGNS THAT DENOTE HAZARDOUS AREAS AROUND THE CONSTRUCTION.

23. GENERAL CONTRACTOR TO ACCEPT, STORE, ASSEMBLE & SET OR RELOCATE SMALL EQUIPMENT SIMILAR TO, BUT NOT LIMITED TO: CART CORRALS, BENCHES, BACKROOM EQUIPMENT, BIKE RACKS, OFFICE FURNITURE, CHAIRS, SHELVES, LAUNDRY CABINET, ETC.

24. GENERAL CONTRACTOR IS TO BID INSTALLING A SPRINKLER SYSTEM UNDER THE FRONT GANTRY. ANTI-FREEZE IS PREFERRED. IF ANTI-FREEZE SYSTEM IS NOT ALLOWED, THEN INSTALL A DRY-LOP SYSTEM. COORDINATE WITH THE CONSTRUCTION MANAGER ON THE COMPRESSOR LOCATION AND POWER REQUIREMENTS. THE SPRINKLER CONTRACTOR MUST INSTALL A TAMPER SWITCH ON THE SHUT-OFF VALVE FOR THE ANTI-FREEZE SYSTEM.

25. GENERAL CONTRACTOR SHALL CONSTRUCT A PLATFORM AROUND THE AIR HANDLER AFTER THE AIR HANDLER IS INSTALLED. PLATFORM SHALL MEET ALL GOHM AND CODE REQUIREMENTS.

26. THE GENERAL CONTRACTOR SHALL CONSTRUCT A PLATFORM FOR THE WATER HEATER ABOVE THE MEN'S RESTROOM - SEE SHEET 16.01F.

27. INSULATE THE CELLS OF THE MASONRY WALLS WITH A MINIMUM "R" VALUE OF 13.7.

28. ALL STAINLESS STEEL THRESHOLDS SHALL BE 304 S/S WITH #2B FINISH AND PROTECTIVE FILM. THRESHOLDS SHALL BE 5" WIDE X 1 1/4" THICK STAINLESS STEEL WITH COUNTERSUNK SCREWS AND SET IN A FULL BED OF SILICONE TO FLOOR. ALL OTHER STAINLESS STEEL SHALL BE 304 WITH #3 FINISH AND PROTECTIVE FILM. COLUMN WRAPS SHALL BE 22 GAUGE STAINLESS STEEL SET ON TOP OF THE FINISH FLOOR TO 4'-0" AFF. FOR ROUND COLUMNS, PROVIDE A 1/2" FOLD OVER HEM LAP SEAM. FOR SQUARE COLUMNS, PROVIDE A 1" LAP SEAM WITH HEMMED EDGE. INSTALL WRAP WITH STAINLESS STEEL RIVETS, 1/2" FROM THE TOP, 2" FROM BOTTOM AND APPROXIMATELY 10"-22" INTERMEDIATELY SPACED. FULLY CAULK TOP AND BOTTOM OF WRAP AND SEAM WITH CLEAR SILICONE SEALANT. CAULK AFTER COLUMN PAINTING IS COMPLETED. OVER/HOOD FLASHING AND BACK-SPLASH SHALL BE 20 GAUGE. ALL OTHER TRIM, DOOR FRAMES, DOOR PLATES, CORNER GUARDS (NON-HEMMED EDGES), ETC. SHALL BE 18 GAUGE STAINLESS STEEL. ALL EDGES SHALL BE DEBURRED AND HAVE RADIUS CORNERS.

29. THE GENERAL CONTRACTOR SHALL PATCH ALL OPENINGS IN MASONRY WALLS. GROUT OR CAULK ALL PENETRATIONS, HOLES AND/OR CRACKS IN ALL WALLS (NEW AND EXISTING). THE VOIDS ON TOP OF ALL MASONRY WALLS MUST BE FILLED AND SEALED WITH A CEMENTITIOUS MATERIAL.

EXTERIOR

30. GENERAL CONTRACTOR SHALL SAND AND REPAINT ANY NEW & EXISTING EXTERIOR GUARDPOSTS WITH "TRAFFIC YELLOW" PAINT.

31. GENERAL CONTRACTOR SHALL SAND, CLEAN AND REPAINT (MIN. 2OF 2 COATS) ALL EXTERIOR METAL INCLUDING BUT NOT LIMITED TO STAIRS, CANOPY SUPPORTS, DOORS AND FRAMES, CART CORRALS, ROOF TOP STEEL, ETC. AS DEPICTED IN THESE DRAWINGS OR AS DIRECTED BY THE FOOD LION CONSTRUCTION MANAGER.

32. ANTI-RODENT COATING - APPLY (1) ONE COAT OF SHERWIN WILLIAMS F7910 SURFACING COMPOUND (PRIMER) AND (2) COATS OF ACRYLON100 URETHANE (FINISH COAT). COLOR TO MATCH EXISTING EXTERIOR COLOR. COORDINATE WITH FOOD LION CONSTRUCTION MANAGER.

33. GENERAL CONTRACTOR SHALL BE RESPONSIBLE FOR HANGING OR REHANGING ENFORCABLE "NO PARKING" SIGNS ON FRONT COLUMNS. THE BOTTOM OF EACH SIGN SHALL BE MOUNTED 6'-0" ABOVE THE FINISHED CONCRETE WALK. SIGNS TO BE PROVIDED BY GC.

34. GENERAL CONTRACTOR IS TO PRESSURE WASH FRONT SIDEWALKS, STORE FRONT MASONRY, VINYL CEILING, AND DUMPSTER PADS ONE WEEK PRIOR TO RE-GRAND. MUST USE HOT WATER AND GENERAL CONTRACTOR IS TO HAVE ALL STOREFRONT GLASS PROFESSIONALLY CLEANED AFTER PRESSURE WASHING THE SIDEWALK DURING THE WEEK PRIOR TO GRAND OPENING.

35. ALL NEW EXTERIOR ALUMINUM CANOPIES SHALL BE A MINIMUM OF 24 GAUGE DECKING. REFER TO SPECIFICATIONS FOR REQUIREMENTS

LEGEND

	NEW METAL STUD WALL FRAMING
	EXISTING WALL
	NEW CONCRETE BLOCK WALL
	NEW BRICK VENEER
	NEW COOLER/FREEZER WALLS
	ROOM NUMBER...SEE SCHEDULE SHEET #A6.01
	DOOR NUMBER...SEE SCHEDULE SHEET #A6.01
	WINDOW MARK...SEE SCHEDULE SHEET #A6.01
	NEW UNI-CARD CORNER PROTECTOR...SEE SHEET #A1.01

YCH
YCH
ARCHITECTS

Architecture
Interior Design
Land Planning
Project Management

Professional Seals

DIEMUS E. YATES
REGISTERED ARCHITECT
6437
WITH CAROLINA
CONCORD, N.C.
01-10-2020

Interior Alteration For:

FOOD LION

2110 Executive Drive, Salisbury, NC 28145 / PH: 704.633.8250

Store No. 22501555 E. UNION STREET
MORGANTON, NC 28655

OWNERSHIP OF INSTRUMENTS OF SERVICE:
All reports, specifications, plans, computer files, field data, notes, and other documents and instruments of service shall remain the property of the Design Professional. The Design Professional shall retain all common law, statutory and other reserved rights, including the copyright thereto.
This drawing is the property of Yates - Chelitzberg - Hughes Architects and is not to be reproduced or copied in whole or any part. It is not to be used on any other project and is to be returned upon request.
© Copyright 2019
Project No.: 2250FLTMHP20
File Name: 2250 A1.03B_00.dwg
Date: 01-10-2020
Revisions:
MEZZANINE FLOOR PLAN
Architectural
A1.03B
YCH Commission Number 19029.00
7035 Northwinds Dr NW
Concord, NC 28027
704 . 788 . 2000
ycharch.com